

DIXION SAFETEST



Scan the code
to watch the operation
demonstration video.

Test yourself at home,
on the journey,
at work.
Protect yourself
and your family!

CONTACT US

DIXION Vertrieb medizinischer Geräte GmbH
Couvenstr. 6, 40211 Düsseldorf, Germany
Tel. +49 211 749583132
www.dixon.de
info@dixon.de

DIXION

DIXION SAFETEST SARS-CoV-2 Saliva Antigen Rapid Test for self-testing

The DIXION SafeTest is used for the qualitative detection of SARS-CoV-2 antigens in sputum (saliva in the back of the throat).

The test is based on the antigen-antibody reaction and the immunochromatography.

It is easy to use with just a sample of saliva and not the complicated nasopharyngeal swab. The collection of the sample is non-invasive, a deep penetration into the nasopharynx is no more necessary and it is more comfortable, gentler and easier for you.



www.saftetest24.de
info@saftetest24.de

THE ADVANTAGES AT A GLANCE



Easy to use

This test is easy to perform. It does not require any specialist knowledge and no additional equipment.



Quick result

The result is available within 10 minutes.



Non-invasive

No need of uncomfortable and sometimes painful nasopharyngeal swabs.



Child-easy performance

Easy operation — convenience through self-test. No help from other family members is required during the test.



High accuracy

Due to the high reliability of the test, the infection status can be determined with high accuracy.

OPERATION — 3 STEPS TO GET A RESULT

1. Collect a sample

Open the cover of the collection tube and screw the saliva funnel onto it. Collect 2 ml of saliva from the deep throat (the collection tube already contains 2 ml of solution). Remove the saliva funnel. Close the tube and shake it vigorously upside down 6 to 10 times.

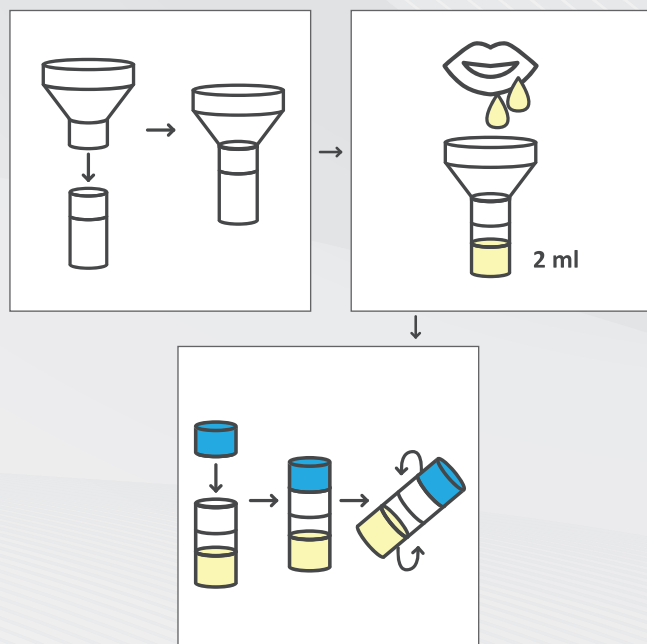

2. Add a sample

Open the cover, leave the tube for 10 seconds and then remove the liquid from the tube with a dropper. Add 3-4 drops (without bubbles and with a 3-second interval) into the sample opening and wait until a purple line is shown.

DIXION

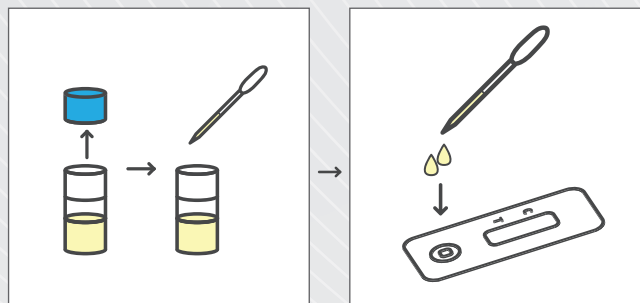

3. Read the result

The test results should be read within 10-15 minutes.

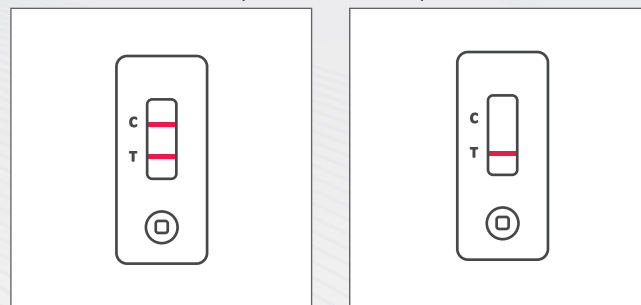
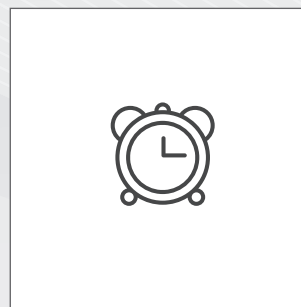

Please refer to the package insert.

INTERPRETING THE RESULTS

Control line →
Test line →

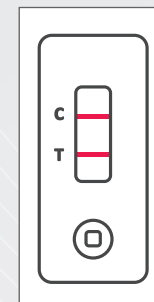

Positive

A purple line appears in both the control line area (C) and the test line area (T).

A positive result means that you are very likely to be infected with COVID-19. Please contact your doctor/family doctor or the local health department immediately.

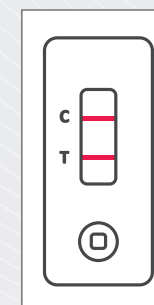

Negative

Only a purple line appears in the control line area (C).

You are unlikely to be infected with COVID-19.

An infection can also be present if the test result is negative. In case of suspicion, it is recommended to repeat the test after 1-2 days.

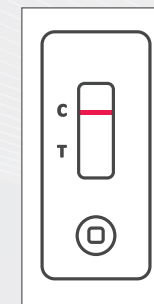

Invalid

A purple line appears in the test line area (T) or no purple line appears in the control line area (C) as an indication that the test was not performed correctly or the test cassette is defective. In this case, the test should be performed again with a new test cassette.

